

BUILDING LAYOUT

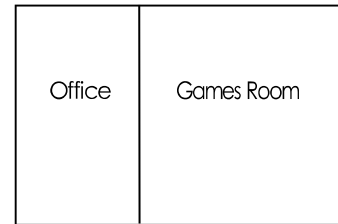
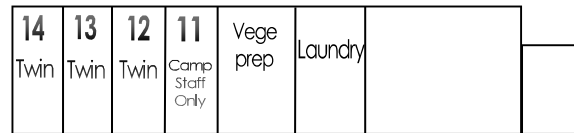
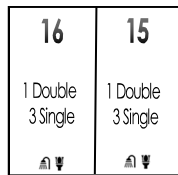
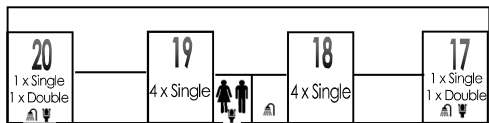
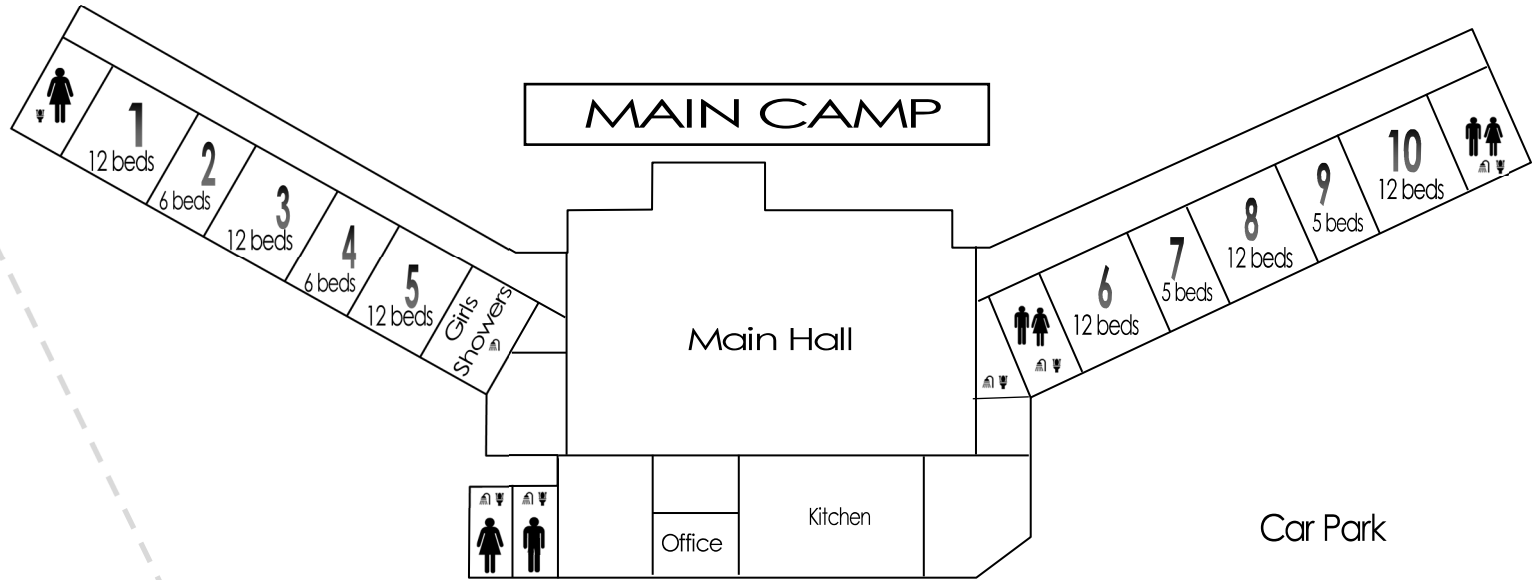
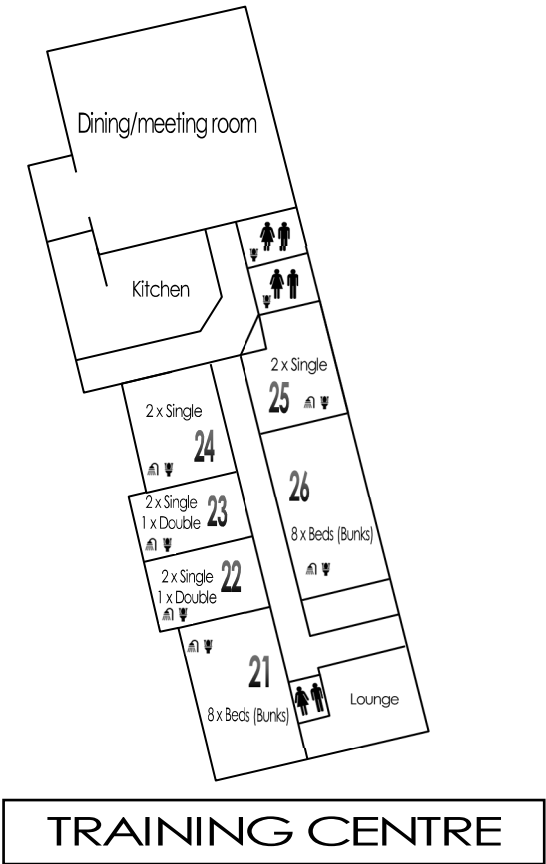

Please confirm with camp staff which cabins have been booked for your group prior to assigning beds.

Description	Location	Double Beds	Single Beds	Toilets	Showers
Main Building (Girls Wing) Bunkrooms	Room 1	-	12 (6 Bunks)	4	4
	Room 2	-	6 (3 Bunks)		
	Room 3	-	12 (6 Bunks)		
	Room 4	-	6 (3 Bunks)		
	Room 5	-	12 (6 Bunks)		
Main Building (Boys Wing) Bunkrooms	Room 6	-	12 (6 Bunks)	5	5
	Room 7	-	5 (2 Bunks + 1 single)		
	Room 8	-	12 (6 Bunks)		
	Room 9	-	5 (2 Bunks + 1 single)		
	Room 10	-	12 (6 Bunks)		
Back Cabins	Room 11	CAMP STAFF ONLY		2 back of main building	
	Room 12	-	2		
	Room 13	-	2		
	Room 14	-	2		
	Room 15	1	4	En-suite	
	Room 16	1	4	En-suite	
	Room 17	1	1	En-suite	
	Room 18	-	4 (2 Bunks)	1	1
	Room 19	-	4 (2 Bunks)		
	Room 20	1	1	En-suite	
Rooms 21-26 only to be used when all other accommodation is full.					
Training Centre	Room 21	-	8 (4 Bunks)	En-suite	
	Room 22	1	2	En-suite	
	Room 23	1	2	En-suite	
	Room 24	2 singles zip together to make King		En-suite	
	Room 25	2 singles zip together to make King		En-suite	
	Room 26	-	8 (4 Bunks)	En-suite	